

1967 CHEVROLET

**CAMPERS  
AND  
PLEASURE  
TRUCKS**







*Series 20 Fleetside Pickup with 10' over-cab camper body*



*Series 20 Stepside Pickup with 10' over-cab camper body*



*El Camino*



*Series 30 Chassis-Cab with frame mounted camper body*



*Sportvan 108 with Chevrolet accessory Custom Deluxe camper conversion*



*Step-Van King camper conversion by Heckaman Mfg. Co.*



*Step-Van camper conversion by Adventureline Mfg. Co.*



# TAKE YOUR PICK FROM THE CHEVY CAMPER LINEUP

Whether you're a camping buff from way back or are about to join this growing group of outdoor enthusiasts, it's a good bet that Chevrolet has exactly what you need in the broad camper lineup for 1967.

Popular favorites are Chevy pickups with separate camper bodies. (For a bonus between trips, slip off the camper unit and you have a workhorse that can handle a hundred different hauling jobs.) Chassis-cabs are wise choices for carrying larger permanently mounted camper bodies.

On the other hand, you may lean toward the luxury and convenience of an all-in-one camping unit. In that case, keep in mind that Chevrolet Sportvans and Step-Vans can be converted into luxurious camper coaches with ease and economy.

If you like to tow your fun along behind you, check into the trailer-hauling capabilities of El Camino or Chevrolet's station wagons and passenger cars.

Whatever way you take your fun—on weekend jaunts or cross-country vacations, over highways or on backwoods trails, in couples or in crowds—Chevrolet has a vehicle you can rely upon. And best of all, every Chevrolet can be tailored to your precise needs with an almost endless variety of optional equipment and accessories. So check the information in this brochure for a better idea of which Chevy fits your needs. Then talk things over with that friendly travel expert, your Chevrolet dealer.

## Things to consider in selecting a camper:

**How many people do you want to accommodate?** Consider not only sleeping accommodations but overall living space, as well. Determine the number of people in your party and allow plenty of room.

**How far will you travel?** Average trip distance is an important consideration, especially when selecting

options and accessories. A few "extras" like a radio or air conditioning can make long drives a lot more pleasant.

**How long will you stay?** Extended journeys require more gear than short trips. If you intend to take trips that will last more than a week, consider a Step-Van conversion—or a large camper coach with sufficient truck to haul it.

**Where will you camp?** Sportvan and Step-Van campers are ideal for highway operation. Pickups and chassis-cabs, with their greater road clearance, should be considered for off-road service.

**How much can you invest?** Modest budgets might indicate a Sportvan conversion or standard ½-ton pickup with a shell camper body. Vehicles like the chassis-cab with camper body and the Step-Van conversion represent a proportionately larger investment.

## FOUR BASIC TYPES OF CAMPERS



**Shell camper body**—for use with ½-ton pickups. Low in cost, its compact dimensions make it easier to haul over narrow trails. Many types of shell-type campers are available.

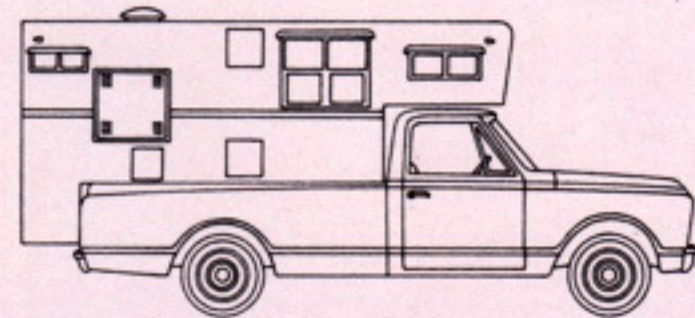

**Cab-over camper body**—for use with ¾- and 1-ton pickups. The extended portion over the cab provides additional head room and sleeping space. Most popular of today's campers.

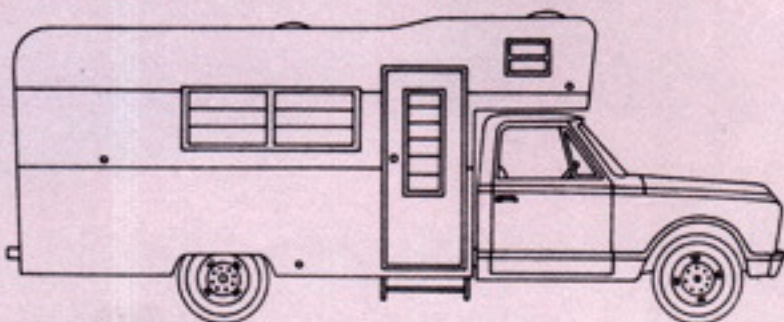

**Frame-mounted camper body**—for use with ¾- and 1-ton chassis-cab models. Increased head room allows full-height side entrance. Low center of gravity results in greater stability.

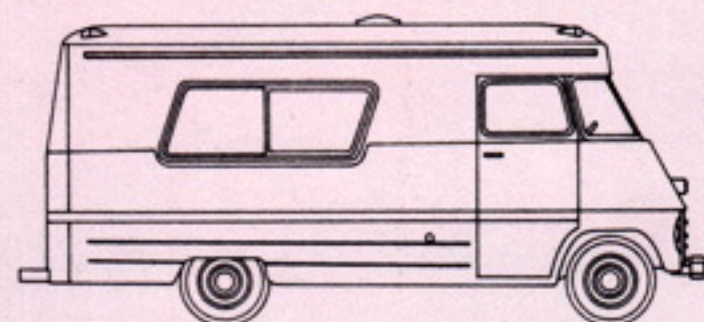

**Self-contained camper conversion**—available on either Sportvan or Step-Van models. Has all the advantages of a camper body/truck combination . . . plus a number of its own.

The above types of camper coaches and conversion units are available from numerous dealers throughout the country. Your Chevrolet dealer will be happy to provide the names of camper dealers in your area and, if you wish, will make specific recommendations regarding the make and size of camper you need plus the equipment you should consider.





Series 20 Fleetside Pickup with 10' over-cab camper body



4 Series 10 Fleetside Custom Sport Truck (CST) with shell camper body

See page 14 for trailer towing recommendations and typical floor plans



# PICKUPS

The thing that makes a Chevy pickup stand out in camper service is the remarkable way it combines truck toughness with an excellent ride. The brawny frame and rugged truck components of a Chevy pickup are ideally suited to hauling a heavy camper body over superhighway or backwoods trail with enough road clearance to cover rough ground. For over-the-road comfort, there's all-around coil spring suspension on 1/2-ton and 3/4-ton models for the kind of smooth ride and easy handling that make you forget you're in a truck. And Chevrolet's new pickup cab for '67 has plenty of room, better visibility and a long list of special safety features. A Chevy pickup requires a minimum of maintenance and holds its resale value exceptionally well. Between trips, it can handle a variety of hauling jobs or provide low-cost transportation to and from work.

For those who want to keep going when the roads stop, Chevy pickups also come in 4-wheel-drive models with a new low silhouette for '67.

They offer the added traction needed to get you back into off-road areas—and get you out, as well.

Chevrolet Fleetside and Stepside pickups come in many lengths and sizes to fit various camping applications. The model you select will be

determined largely by the size and type of camper body you require, and the amount of equipment and people you expect to carry. The chart below will be helpful in selecting the most suitable model and equipment for your personal needs.

## CAMPER COACH RECOMMENDATIONS

Camper Body Type	Shell		Over-Cab	
	6	8	9	10
Body Length (ft.)	6	8	9	10
Body Weight (lbs.)	200	400	1100	1400
Passenger & Equipment Weight (lbs.)	500	600	700	1000
Recommended Chevrolet Model	CS10734 CE10734	CS10934 CE10934	CS20904 CE20904 CS20934 CE20904	CS20904 CE20904 CS20934 CE20934
Engine	*250 Six **283 V8 292 Six 327 V8	*250 Six **283 V8 292 Six 327 V8	*250 Six **283 V8 292 Six 327 V8	292 Six **283 V8 327 V8
Transmission	3-Speed ■ 3-Speed 4-Speed 4-Speed CR Powerglide Turbo Hyd.	3-Speed ■ 3-Speed 4-Speed 4-Speed CR Powerglide Turbo Hyd.	3-Speed 4-Speed 4-Speed CR Powerglide Turbo Hyd.	3-Speed 4-Speed 4-Speed CR Powerglide Turbo Hyd.
Rear Axle Capacity (lbs.) Ratio	3500 3.73	3500 3.73	5200 4.11	5200 4.11
Springs Front—Capacity (lbs.) Rear—Capacity (lbs.) Auxiliary Rear—Capacity (lbs.)	1250 1250	1250 1250 500	1250 2000 500	1250 3000 500
Tires Front Rear	8.15-15-4 Pr 8.15-15-4 Pr	7.00 x 15-6 Pr 7.00 x 15-6 Pr	7.50 x 16-6 Pr 7.50 x 16-6 Pr	7.50 x 16-6 Pr 7.50 x 16-8 Pr

■ 3-Speed fully synchronized transmission available as an option on series 10 trucks only with the 250 Six. Included as standard equipment with all other engines in the 10 series and all 20 series trucks. CR—Close-Ratio. Equipment shown in blue optional at extra cost. \*Standard on 6-cylinder models. \*\*Standard on V8 models.



See page 14 for trailer towing recommendations and typical floor plans

Series 20 Stepside Pickup with 10' over-cab camper body



# CUSTOM SPORT TRUCK

If you like to travel in style and comfort, the new Chevrolet Custom Sport Truck is for you. Deep foam-cushioned vinyl bucket seats make long trips seem shorter. Lift up the center armrest and you can accommodate a third party on the padded console/seat. Luxury-size quiet comes from such thoughtful touches as full-floor carpeting, extra insulation and special undercoating. Other interior conveniences include armrests on both doors, two padded sunshades and a cigarette lighter. Outside, there's a chrome front bumper, bright metal trim and special CST identification to tell the world you're going first class. You order this luxury package on any Chevrolet pickup or light-duty chassis-cab model you choose.



You don't have to be a truck expert to custom-tailor a Chevy pickup or chassis-cab unit specifically for camping duty. Chevrolet makes it easy—all you have to do is tell your dealer you want the Custom Camper equipment. You'll get a rugged vehicle that's ready to complement the camper body of your choice, beefed up for years of rigorous camping service. Special suspension components and tires let you travel with a

greater margin of comfort and safety. And when the going gets rough, you'll appreciate the exceptional handling ease that comes from owning a Chevrolet Custom Camper.

You can order Custom Camper equipment on any 10 or 20 series Fleetside or Stepside pickups and on 20 or 30 series chassis-cab models. So select the vehicle that fits your needs and let your Chevrolet dealer fit it out for your pleasure.

## Custom Camper Equipment

**Series 10 (1/2-ton)** Special Custom Camper Nameplate; Front Stabilizer Bar; 2000-lb. Rear Springs or 500-lb. Auxiliary Rear Springs; Heavy-Duty Shock Absorbers; Choice of the following tire sizes: 7.00-15, 6.50-16, 8-16.5.

**Series 20 (3/4-ton)** Special Custom Camper Nameplate; Front Stabilizer Bar; 3000-lb. Rear Springs or 500-lb. Auxiliary Rear Springs; Heavy-Duty Shock Absorbers; Choice of the following tire sizes: 7.50-16, 7.00-17, 7.50-17, 8.75-16.5, 9.50-16.5, 10-16.5.

**Series 30 (1-ton)** Special Custom Camper Nameplate; Front Stabilizer Bar; 3100-lb. or 4150-lb. Rear Springs; Heavy-Duty Rear Shock Absorbers; Choice of the following tire sizes: 7.00-16 Dual Rear, 7.50-16 Dual Rear, 7.00-18 Dual Rear, 8.75-16.5, 9.50-16.5, 10-16.5.





Series 30 Chassis-Cab with frame mounted camper body

## CHASSIS-CAB

For longer camping trips—or larger camper body—a Chevrolet chassis-cab rates prime consideration. With this type of rig, the camper body is permanently attached to the chassis, forming a solid integral unit with a low center of gravity. This setup results in easier, safer handling both on and off the highway. Just as important is the fact that a Chevy chassis-cab can carry an extra-large camper body—up to 14 feet long—with plenty of head room and gear storage space. Another significant advantage of chassis-cab campers is the full-height side entrance for easier entry. Chevrolet chassis-cab models come in  $\frac{3}{4}$ -ton and 1-ton models with a wide assortment of options, including V8 engines, heavy-duty suspensions, dual rear wheels, off-road tires and many others.

See page 14 for typical floor plans.

### CAMPER COACH RECOMMENDATIONS

Camper Body Type	Chassis Mounted		
	10	11	14
Body Length (ft.)	10	11	14
Body Weight (lbs.)	1600	1700	2000
Passenger & Equipment Weight (lbs.)	1800	1900	1900
Recommended Chevrolet Model	CS20903 CE20903	CS31003 CE31003	CS31403 CE31403
Engine	292 Six 327 V8	292 Six 327 V8	292 Six 327 V8
Transmission	*3-Speed 4-Speed 4-Speed CR	4-Speed 4-Speed CR	4-Speed 4-Speed CR
Rear Axle Capacity (lbs.) Ratio	5200 4.57	7200 4.57	7200 4.57
Springs Front—Capacity (lbs.) Rear—Capacity (lbs.) Auxiliary Rear—Capacity (lbs.)	1250 3000 500	1500 3100	1500 4150
Tires Front Rear	6.50 x 16-6 Pr 6.50 x 16-6 Pr Dual	6.50 x 16-6 Pr 6.50 x 16-6 Pr Dual	7.00 x 16-6 Pr 7.00 x 16-6 Pr Dual

\*Fully synchronized. CR—Close-Ratio. Equipment shown in blue optional at extra cost.



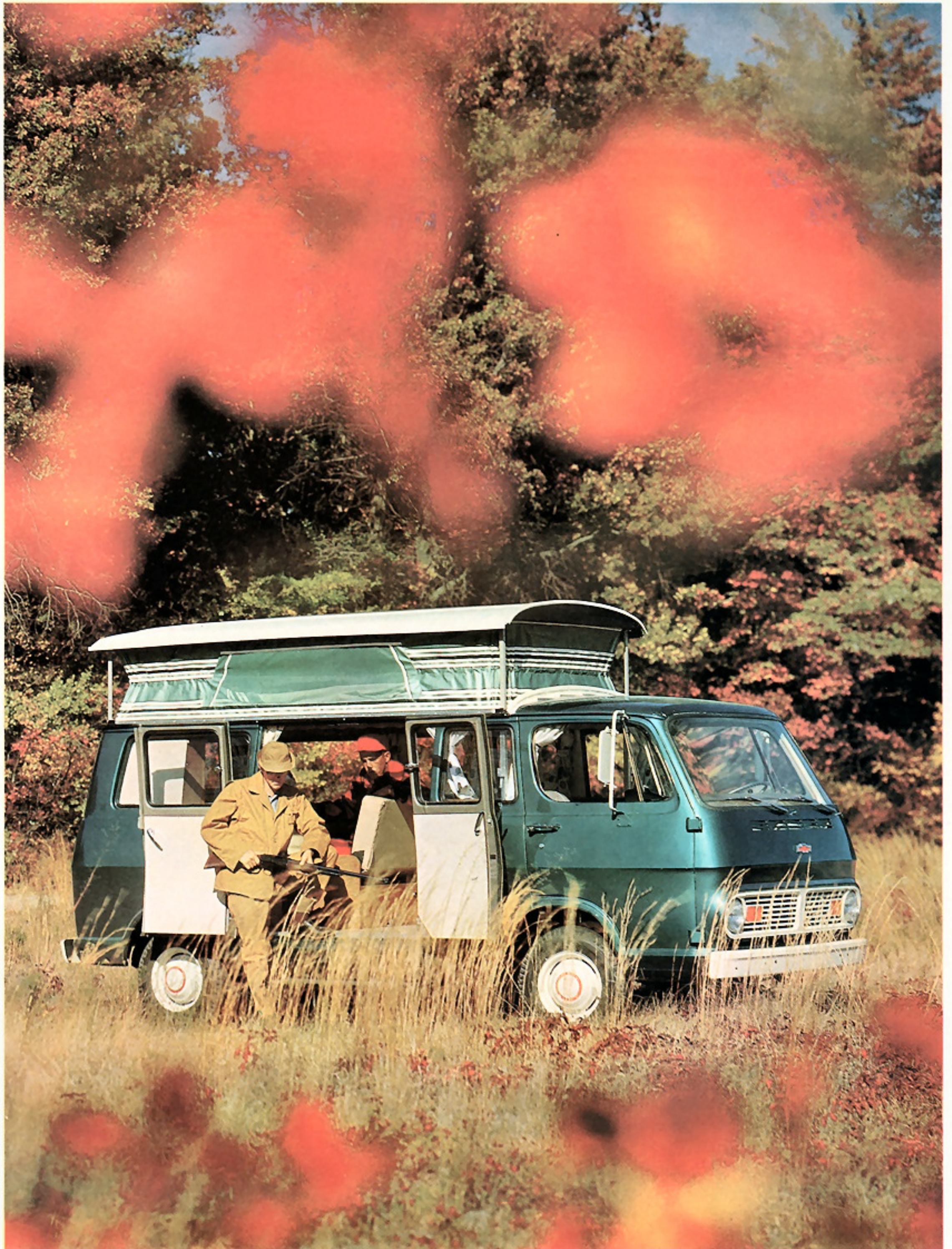

*Sportvan 108 with Travel Equipment Co. camper conversion*

*See page 14 for typical floor plans.*





*Sportvan 108 with Chevrolet accessory Custom Deluxe camper conversion*

## SPORTVAN

With big rear and side loading doors, an immense flat cargo area and seating available for up to eight adults, a Sportvan is ready for fun the way it comes. But Sportvans also can be outfitted especially for camping with any one of several conversion units. A typical conversion includes beds, wardrobe, stove, sink, ice box and  
*See page 14 for typical floor plans.*

dinette table. For 1967, Sportvan comes in two distinct sizes — the regular Sportvan 90 with 204 cubic feet of space, or the big Sportvan 108 with an extra foot and a half of load length, longer wheelbase and a generous 252 cubic feet of volume. The Sportvan 108 can carry nearly a ton and a half of camping gear and

campers. Whichever Sportvan fits your needs, you can choose from two big 6-cylinder engines *and* a husky V8. And you get the durable corrosion resistance and superb handling that are a hallmark of Chevrolet's Sportvan. Just the ticket when you carry small groups, take short trips and stick close to good roads.





*Step-Van King camper conversion by Adventureline Mfg. Co.*

*See page 14 for typical floor plans.*





*Step-Van camper conversion by Adventureline Mfg. Co.*

## STEP-VANS

First choice for long trips, large groups and luxury, a Chevy Step-Van conversion can be truly a home on wheels. Loads of room—up to 497 cubic feet of it—allow plenty of space for bunks, shower, chemical toilet, sink, refrigerator and many more conveniences. Bred from a long line of tough delivery vehicles—the kind that rack up many years of trouble-free use—Step-Vans offer a choice of 6-cylinder engines that blend spirited performance with outstanding fuel economy. Whether you select the big Step-Van King, the regular Step-Van or the Step-Van 7, you can have yours with such luxuries as nylon carpeting, sliding windows with screens, curtains and wood cabinets. There's no better way to take the "rough" out of roughing it.

*See page 14 for typical floor plans.*



*Step-Van 7 camper conversion by Adventureline Mfg. Co.*





## EL CAMINO

El Camino means "the road", and that's where this dual-personality Chevrolet is at its best. It has all the good looks, smooth ride and crisp handling of a passenger car. Yet the spacious El Camino pickup bed can carry up to a thousand pounds of cargo. With all that room for camp-

ing gear—plus the ability to pull a trailer—El Camino is a popular pleasure vehicle with a wide range of capabilities. Coil spring suspension with air-booster rear shock absorbers makes the bumps disappear. Interiors feature vinyl appointments and a full complement of safety fea-

tures found on Chevrolet's '67 passenger cars. El Camino engines range from economical sixes to a high-performance 396-cubic-inch V8. For campers who want all the beauty and comfort of a fine passenger car *plus* the utility of a tough pickup, El Camino is a good choice.





## *Passenger car trailer-towing*

If you belong to the large group of campers who prefer to tow their fun along, remember that 1967 Chevrolet passenger cars make excellent trailer-pulling vehicles. It makes no difference whether you want to haul a boat, a travel trailer or a load of camping gear, there's a Chevrolet

designed to do the job. To accommodate the added weight and bulk of a trailer, Chevrolet offers a large selection of specialized equipment that can multiply the pleasure of trailer-towing travel. As a matter of fact, your Chevrolet dealer can supply you with the latest edition of our

trailer-towing booklet. Here you'll find a detailed account of the trailer-towing capabilities of each line of Chevrolet passenger cars, a complete listing of special equipment available plus a wealth of helpful hints on trailering techniques. It's a booklet every trailer owner should read and remember.



# TRAILER TOWING RECOMMENDATIONS

For El Camino trailer towing recommendations see the passenger car trailer towing booklet.

Pickups

## TRAILER WEIGHTS AND HITCH CLASSES

## TRAILER USE DEFINITIONS

Trailer Hitch Classification	Gross Trailer Weight	Maximum Tongue Load	Occasional	Extensive
Light-Duty Medium-Duty Heavy-Duty	Under 2000 lbs. 2000 to 3500 lbs. 3500 to 5000 lbs.	Under 100 lbs. 100 to 200 lbs. 200 to 400 lbs.	Under 2000 miles of trailer hauling per year in boat or travel trailer hauling on weekends or short vacations.	Over 2000 miles of trailer hauling per year, such as cross-country, caravan or extended vacation driving.

Truck Series	CS/CE 10 (1/2 Ton)				CS/CE 20 (3/4 Ton)					
	Light-Duty		Medium-Duty		Light-Duty		Medium-Duty		Heavy-Duty	
Trailer Use	Occasional	Extensive	Occasional	Extensive	Occasional	Extensive	Occasional	Extensive	Occasional	Extensive
Trailer Hitch-Type	Frame Mounted		Frame Mounted	Frame Mounted or Equalizer	Frame Mounted		Frame Mounted	Frame Mounted or Equalizer	Frame Mounted or Equalizer	
Front Suspension	Standard		Standard		Standard		Standard		Standard	
Rear Suspension	Standard		Standard		Standard		Standard		Standard	
Brakes	Standard		Standard		Standard		Standard		Standard	
Engine	Standard		Standard	250 Six* 292 Six 283 V8 327 V8	Standard		Standard	250 Six* 292 Six 283 V8 327 V8	292 Six 283 V8 327 V8	
Clutch	Standard		Standard	11"	Standard		Standard	11"	11"	
Transmission	Standard		Standard	3-Speed** 4-Speed#	Standard		Standard	3-Speed** 4-Speed	4-Speed	
Electrical	42 Amp. Delcotron 70 Amp.-Hr. Battery		42 Amp. Delcotron 70 Amp.-Hr. Battery		42 Amp. Delcotron 70 Amp.-Hr. Battery		42 Amp. Delcotron 70 Amp.-Hr. Battery		42 Amp. Delcotron 70 Amp.-Hr. Battery	
Tires	7-17.5-6 PR		7-17.5-6 PR		8-17.5-6 PR		8-17.5-6 PR		8-19.5-6 PR or 8-19.5-8 PR	

\*With 4-speed transmission only.

\*\*With 292 Six or V8 engines only.

# 11" Clutch must be ordered when the 250 Six engine is used.

# Must be used with the standard 250 Six engine. Can be used with the 292 Six or V8 engines depending upon the owner's choice.

Equipment shown in blue optional at extra cost.

## TYPICAL FLOOR PLANS

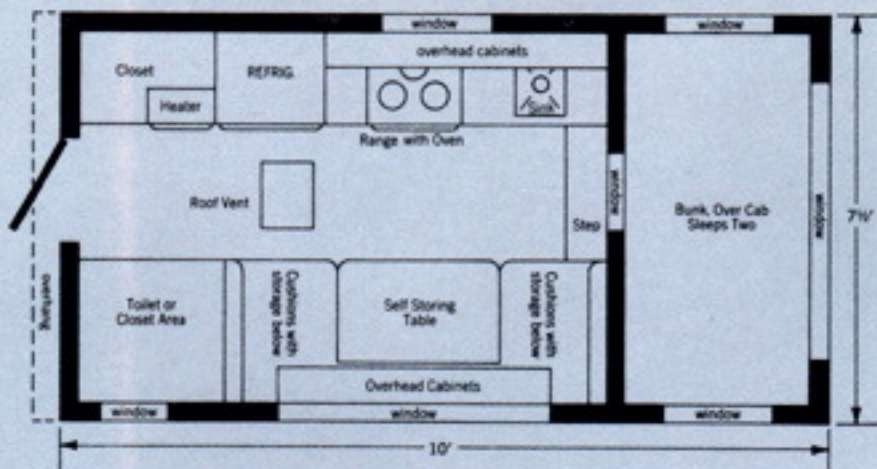

Over-Cab Pickup Camper Body

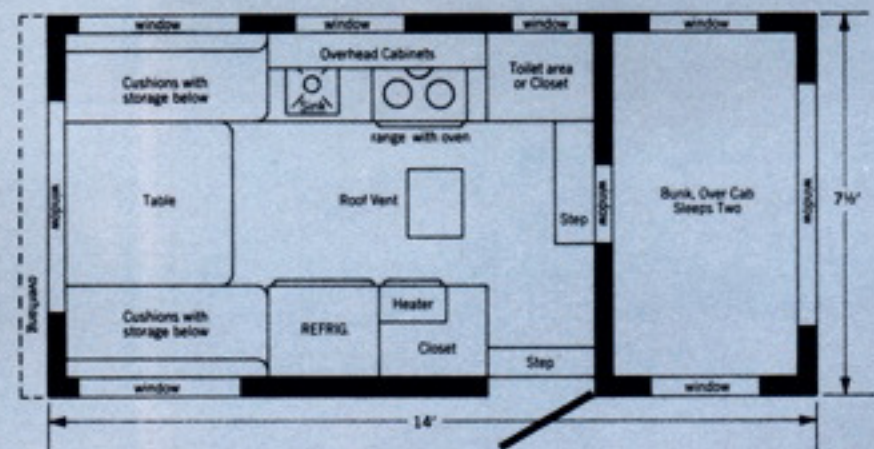

Over-Cab Frame Mounted Camper Body

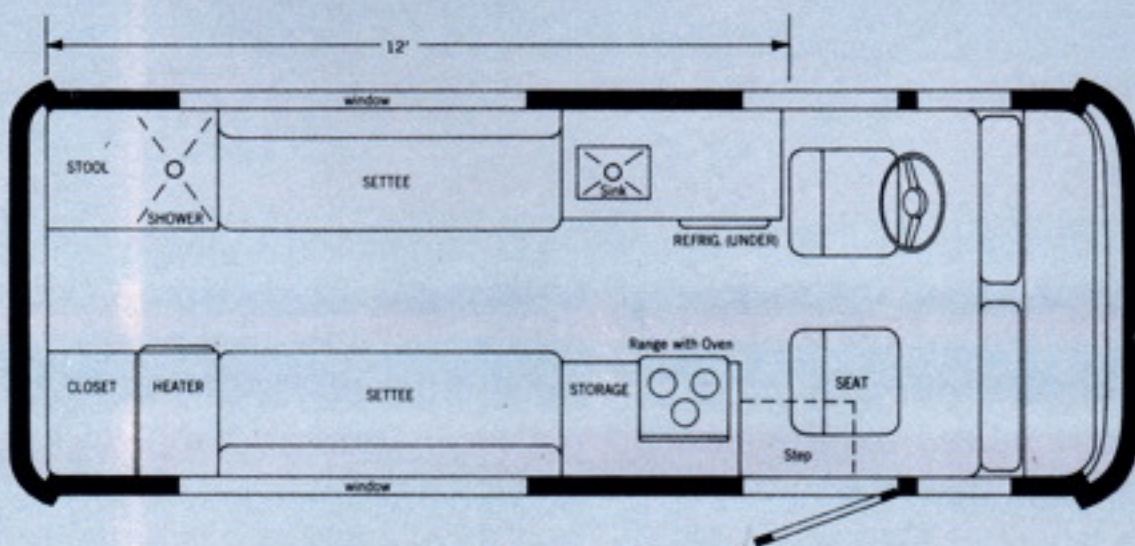

Step-Van Conversion

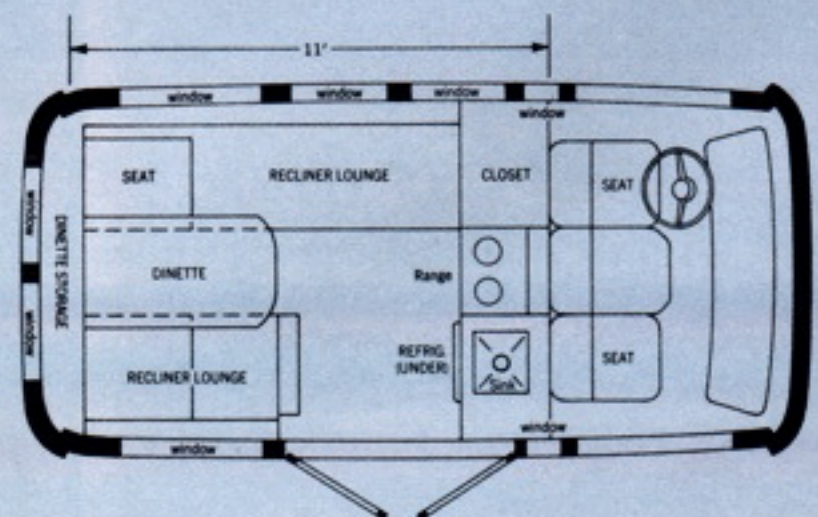

Sportvan Conversion



# CHEVROLET CAMPER OPTIONS AND ACCESSORIES

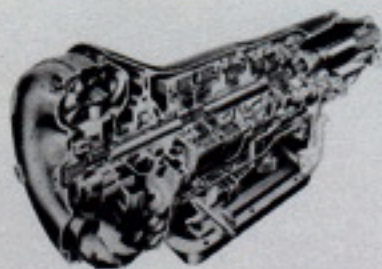

**Automatic Transmission**—Selects most suitable ratio to keep engine in best power range and cushions shifts to smooth power flow.



**All-Weather Air Conditioning**—Cools, cleans and dehumidifies air for total comfort. Includes heavy-duty radiator and Delcotron generator.

**Power Steering**—Reduces driver fatigue, helps make parking and low-speed maneuvering easier. Desirable when wife shares driving.



**NoSPIN Rear Axle**—Delivers power to the rear wheel with the most traction. Reduces wheel-spinning when driving in mud or sand, on snow or ice.

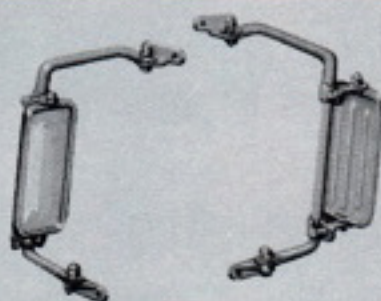

**Side-View Mirrors**—Large adjustable mirrors can be mounted on right or left side of cab for excellent view of the rear.

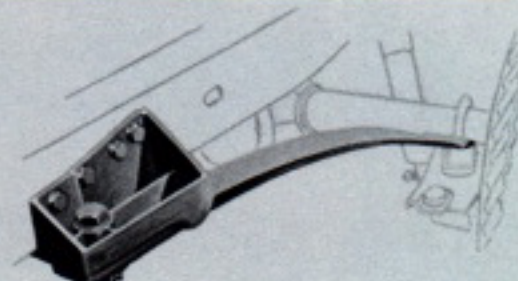

**Auxiliary Rear Leaf Springs**—Add extra payload capacity to pickup models, cut unnecessary strain from extreme service conditions.

**Fire Extinguisher**—Approved by Underwriters Laboratories, I.C.C. and U.S. Coast Guard for marine use. Two and three quarter pound capacity.

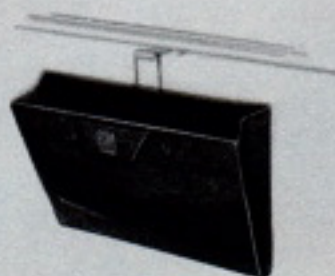

**Litter Container**—A plastic container that fits to the edge of the instrument panel. Snaps off and on for easy litter disposal.



**Highway Emergency Kit**—Includes a fire extinguisher, tire inflator, "Day Glo" flags, two 15-minute flares and assorted electrical fuses.

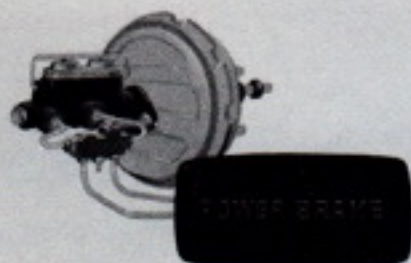

**Power Brakes**—Reduce pedal effort substantially, even with heavy loads. Low-pedal-type brake assures smooth, positive stops.



**Portable Hand Spotlight**—A handy trouble lamp with a long twelve-foot cord that can be used in any 12-volt cigarette lighter.

- Heavy-duty Battery
- Commercial Grille Guard
- Heavy-duty Radiator
- Pushbutton Radio
- Heavy-duty Shock Absorbers



